

**Weldable reinforcing steels - class B 420 B**

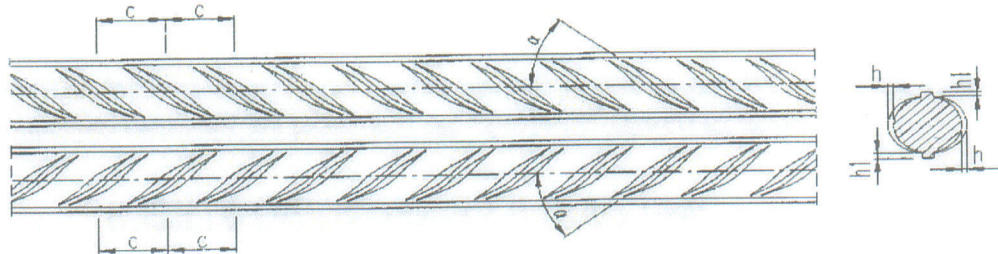

**Nominal diameter, No: No: 8,10, 12, 14, 16, 18, 20, 22, 25, 28, 32, 36, 40**

**Mechanical properties:**

- Yield strength (  $R_e$  ) – **min. 420 MPa**
- Tensile strength (  $R_m$  ) – **min. 460 Mpa**
- Percentage total elongation at maximum force (  $A_{gt}$  )- **min. 5%**
- Percentage elongation (  $A_5$  ) – **min. 14 %**
- $R_m / R_e$  – **min. 1,08**

**Chemical composition of the product:**

C %	P %	S %	N %	Cr %	Ni %	Cu %
max 0,29	max 0,045	max 0,050	max 0,014	max 0,35	max. 0,35	max 0,65

Date: 08/06/2009  
Sofia

Director of "Conformity Assessment" Dept.  
T. Lyubenova

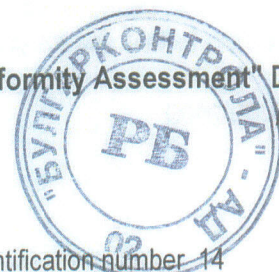

BULGARKONTROLA S.A. – Sofia with identification number 14  
Permit № РОССП-14/24.01.2008 г., issued by MRRB